

customer **care** hotline  
main **office**

**Chef's Magic Trade Center**

1st floor, CYA Bldg. Morato St., San Francisco Del Monte, Quezon City

+ 63 2 376 - 2287 to 90 local nos. 111 to 113 & 115

+ 63 2 374 - 4576 (telefax)

Distributed by: AHAM CORPORATION

For inquiries call our hotline 374 - 4567 to 74

CYA Building Morato Street, San Francisco

Del Monte, Quezon City, 1104 Philippines

AMERICAN HOME<sup>®</sup>

owner's manual

Thank you

for purchasing AMERICAN HOME<sup>®</sup> washing machine

Carefully read this instruction manual before operating the unit.

top.load.washing.machine

AWF-M7020D

7kg capacity

## Contents

Safety precautions.....	1
Part's name.....	3
Accessories.....	4
Specifications.....	4
Installation.....	5
Operation.....	9
Control panel.....	11
Washing program.....	13
Maintenance.....	15
Troubleshooting.....	17

## Safety Precautions



### WARNING

- This appliance is for indoor use only.
- Do not put washing machine at humid place.
- Hands must not be inserted into running spin-dry tub.
- If the spin-dry tub does not stop within 15seconds after opening the cover, please stop using the machine and have it repaired.
- Before doing any maintenance and repair, unplug the appliance from the socket.
- Always unplug the machine and turn off the water supply after use.
- To ensure safety, check carefully and make sure that your socket is properly and reliably earthed.
- Make sure that the water and electrical devices must be connected by a qualified technician in accordance with the manufacturer's instructions and local safety regulations.
- Make sure that the water and electrical devices must be connected by a qualified technician in accordance with the manufacturer's instructions and local safety regulations.

## Safety Precautions



### WARNING

- This appliance is not intended for use by persons (including children) with reduced physical, sensory or mental capabilities or lack of experience and knowledge unless they have been given supervision or instruction concerning use of the appliance by a person responsible for their safety.
- Children should be supervised to ensure that they do not play with the appliance.
- If the supply cord is damaged, it must be replaced by the manufacturer, its service agent or similarly qualified persons in order to avoid a hazard.
- The openings must not be obstructed by a carpet.
- Remove all packages before using the appliance.
- Plug must be accessible after installation.
- Do not climb up and sit on top cover of the machine.
- The washing machine with single inlet valve only can be connected to the cold water supply. The product with double inlet valves should be correctly connected to the hot water and cold water supply.
- Do not lean against machine door.
- Cautions during Handling:
  1. Transport bolts shall be reinstalled to the machine by a specialized person.
  2. The accumulated water shall be drained out of the machine.
  3. Handle the machine carefully. Never hold each protruded part on the machine while lifting. Machine door can not be used as the handle during the conveyance.
  4. This appliance is heavy. Transport with care.
- Before washing clothes the first time, run the machine in one round cycle empty.
- Do not wash or dry articles contaminated with combustible or explosive substances (such as wax, oil, paint, gasoline, degreasers, dry-cleaning solvents, kerosene, etc.) This may result in fire or explosion.
- Select detergents suitable for machine washing, especially for drum.
- Sharp and hard items such as coin, brooch, nail, screw or stone etc. must be removed from the clothes to prevent serious damage to the machine.
- Please do not open the door if there is still water visible. Open the door once the water has been completely drained.
- Be careful when the machine drains hot washing water to prevent scalding.
- Never fill water by hand during washing.
- After the program is completed, please wait for two minutes before opening the door.

## Part's Name

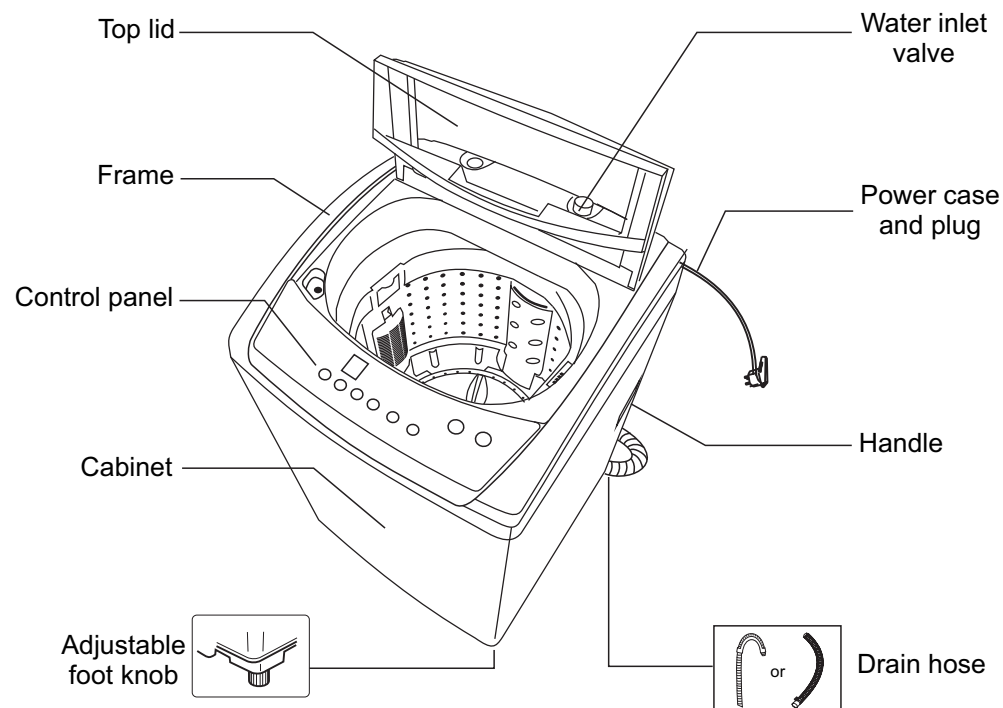

The picture above is for illustration only. There might be a slight difference with the actual unit purchased.

## Accessories

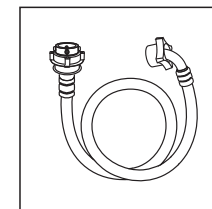

Inlet hose

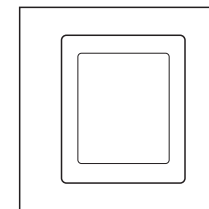

Cabinet baseboard

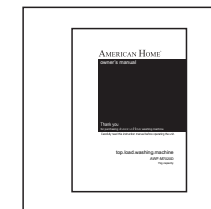

Manual

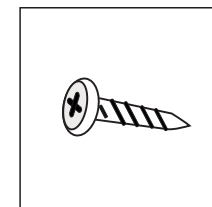

Screw

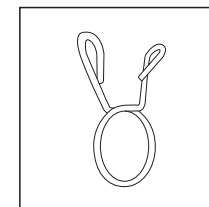

Spring clamer

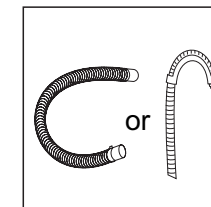

Drain loose

**Note:** If the drain hose is already installed on the machine during purchase, spring clamer and a separate drain hose are not included anymore.

## Specification

<b>Model</b>	AWF-M7020D
<b>Rated Capacity</b>	7kg
<b>Power Supply</b>	230V~ 60Hz
<b>Rated Power</b>	400W
<b>Water Pressure</b>	0.03-0.8Mpa
<b>Grade Of Waterproof</b>	1px4
<b>Net Dimension (WxDxH)</b>	20.28" x 20.67" x 35.83"
<b>Gross Dimension (WxDxH)</b>	23.64" x 23.03" x 38.19"
<b>Net Weight</b>	30kg
<b>Gross Weight</b>	34kg

## Installation

### UNPACKING THE WASHING MACHINE

- Packaging material (e.g. films, styrofoam) can be dangerous for children.
- There is a risk of suffocation. Keep all packaging away from children.
- Remove the cardboard box and styrofoam packing.
- Lift the washing machine and remove the base packing.
- Remove the tape securing the power supply cord and drain hose.
- Remove the inlet hose from the drum.

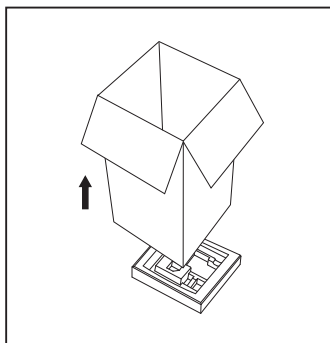

### INSTALLATION AREA

- Make sure that the washer is on a stable position to prevent the product from moving.
- Make sure that the product should not stand on the power cord.
- Before installing the machine, select an area considering the following:
  1. Rigid, dry, and level surface.
  2. Avoid direct sunlight.
  3. Sufficient ventilation.
  4. Room temperature is above 0°C.
  5. Keep far away from the heat resources such as coal or gas.

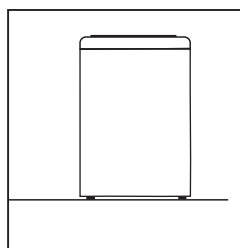
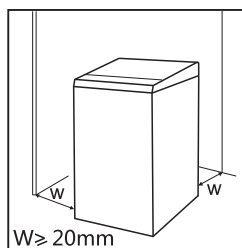

## Installation

### INSTALLATION OF DRAIN HOSE

Drain hose inserted into the drain

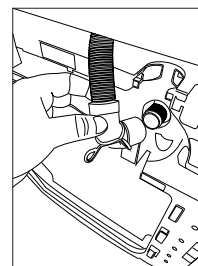

Clamping spring

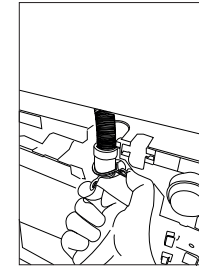

- Do not twist or curve the drain hose.
- Position drain hose properly to prevent water leakage.
- If drain hose is too long, do not force it into washing machine as it will cause abnormal noise.

There are two ways to place the end of drain hose:

#### 1. For lower drain system

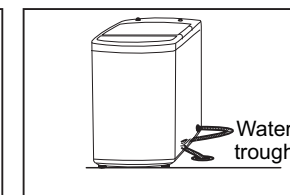
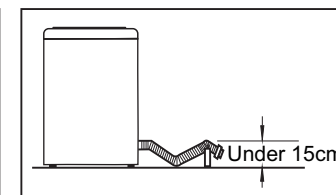
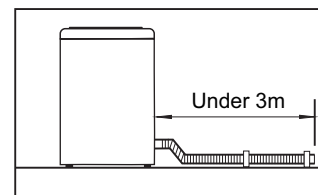

#### 2. For upper drain system

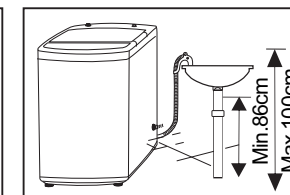
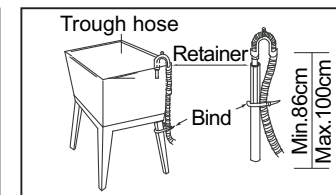
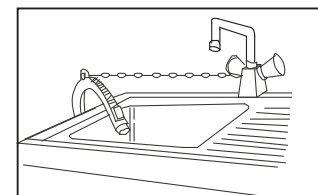

## Installation

### LEVELLING THE WASHING MACHINE

• The lock nuts on all four feet must be screwed tightly against the housing.

1. Check if the legs are closely attached to the cabinet. If not, please turn them to their original positions and tighten the nuts.
2. Check alignment of the product with a level and align if required.
3. Loosen the lock nut and turn the feet until it closely contacts with the floor.
4. After being locked properly, press four corners again to make sure that they have been adjusted properly.

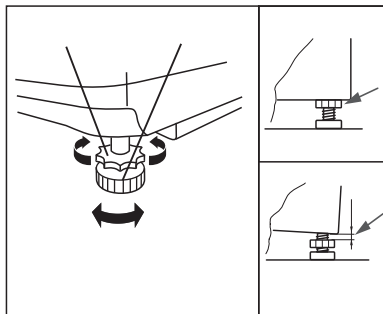

### SELECTION OF FAUCET

Please select appropriate faucet.

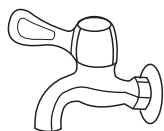

Ordinary faucet



Screw faucet



Special washing machine faucet

AMERICAN HOME®

Laundry Solution

7

## Installation

### CONNECTION OF INLET HOSE, FAUCET AND WASHING MACHINE

#### 1. Connection between ordinary faucet and inlet hose.

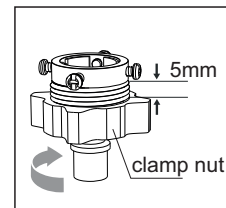

Loosen clamp nut to show 5mm thread

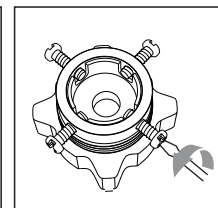

Loosen four bolts

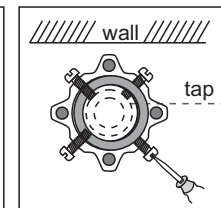

Set connecting base on the faucet and tighten bolts evenly

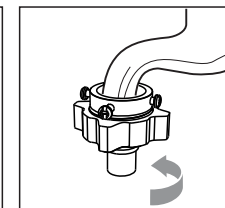

Tighten clamp nut

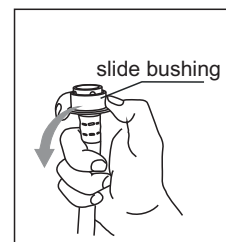

Press slide bushing, insert inlet hose into connecting base

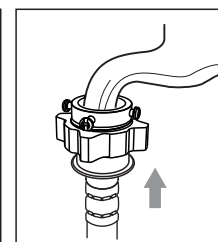

Connection finished

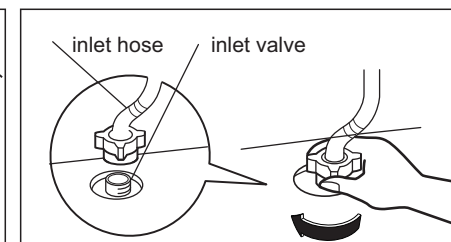

After connection and installation, check if there is water leakage

#### 2. Connection between screw faucet and inlet hose.

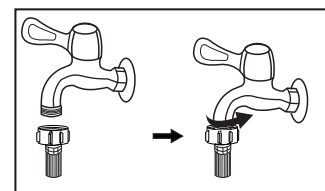

Faucet with threads and inlet hose

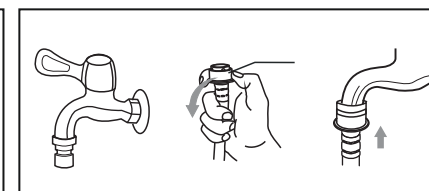

Special faucet for washing machine

AMERICAN HOME®

Laundry Solution

8

## Operations

### PREPARATIONS BEFORE WASHING

#### ! CAUTION

- Before washing, please make sure that the washer is properly installed.
- Before washing it at first time, the washing machine shall be operated in one full cycle without clothes in it following the procedure below except #3. Then include #3 in the procedure once actual washing is to be done.

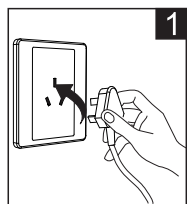

Plug in.

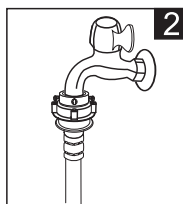

Open the faucet

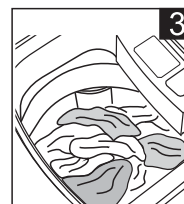

Put in load and close door

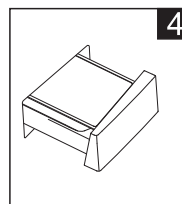

Add detergent

### WASHING

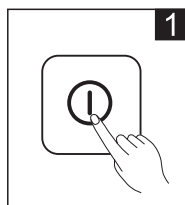

Power on

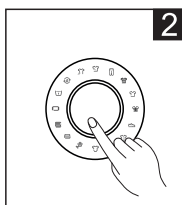

Select program

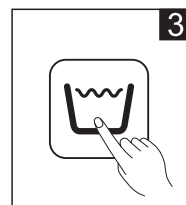

Select water level



Press Start/Pause button to start

After washing has finished, buzzer sounds and the power supply will cut off automatically. Unload the laundry.

AMERICAN HOME®

Laundry Solution

9

## Operations

- The working condition of the washer should be (0-40)°C.
- Please check the labels and the explanation on detergent use before washing. Non-foaming or less-foaming detergent is suitable for use in this machine.

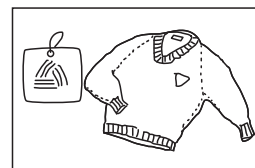

Check the label

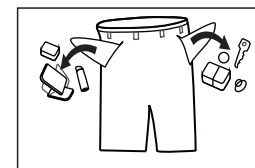

Take out the items out of the pockets

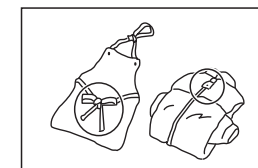

Knot the long strips, zippers, or button

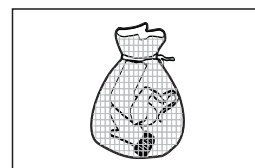

Place small laundry inside a net

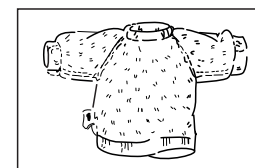

Turn easy-pilling and long-pile fabric inside out

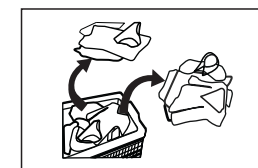

Separate clothes with different textures

- Washing one piece of cloth may easily cause great eccentricity and alarm with sound due to unbalanced load. To prevent this, it is suggested to add one or two more clothes to be washed together so that draining can be done smoothly.
- Do not wash clothes with kerosene, gasoline, alcohol and other flammable materials.

### USAGE OF DETERGENT AND WASHING POWDER

- Dilute semi solid (agglomerated) detergent before placing them into the detergent box to prevent blocking of the inlet which may cause back flow while filling water.
- Please choose suitable type of detergent for the various washing temperature to get the best washing performance with less water and energy consumption.

AMERICAN HOME®

Laundry Solution

10

## Control Panel

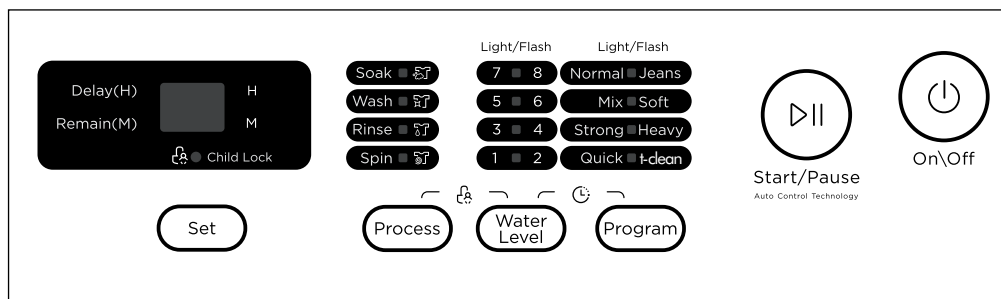

**Note:** The chart is for illustration only. There might be a slight difference with the actual unit purchased.

- 1 **On / Off**  
Product is switched on or off.
- 2 **Start / Pause**  
Press the button to start or pause the washing cycle.
- 3 **Program**  
Available according to the laundry type.
- 4 **Option**  
This allows you to select an additional function and will light when selected.
- 5 **Display**  
The display shows the settings, estimated time remaining, options, and status messages for your washer. The display will remain on through the cycle.

When LED flashing, it means the time that delay to start the machine. When LED lighting it means the program time that remaining. When the number/s on LED display is blinking, delay function is in operation. When the number/s on LED display is steady, it is the remaining time of the cycle.

## Control Panel



### WATER LEVEL

Select water level according to clothing categories, degree of soiling and washing habits of customers.

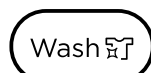

### WASH / RINSE / SPIN

Washing time, rinsing times, spinning time and other settings can be selectable.



### DELAY

1. Select a program.
2. Press the "Delay" button to choose the time.
3. Press "Start / Pause" button to commence the delay operation.

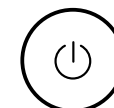

On



Choose the Program



Setting time



Start

Press the "Delay" button until the Delay light is off. It should be pressed before starting the program. If the program already started, should press the "On/Off" button to reset the program.



### CHILD LOCK

Press the "Rinse" and "Spin" button to activate the function. The Child lock will lock all buttons except "On/Off" button.

## Washing Program

Customers can select washing program according to actual demand, and set washing time, rinsing times, spinning time, water volume and appointment time.

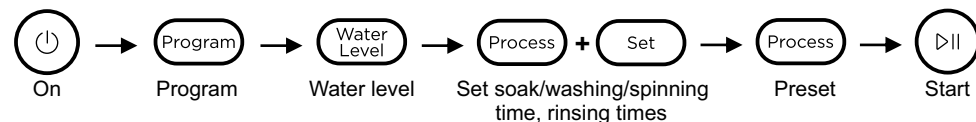

Customers can select washing program according to actual demand, and set rinsing number of times, water volume and time.

### Soak

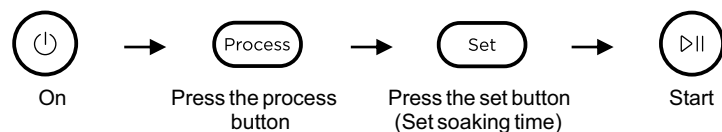

### Wash

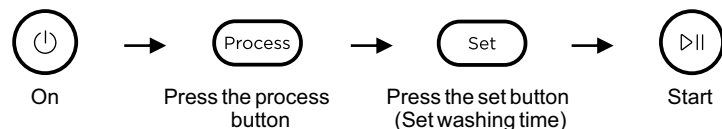

### Rinse

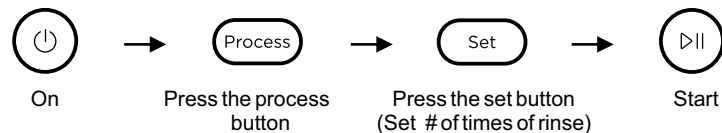

### Spin

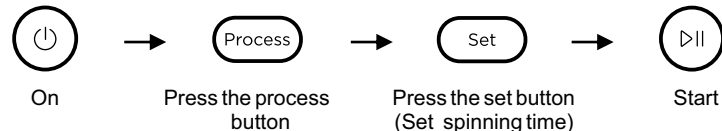

AMERICAN HOME®

Laundry Solution

13

## Washing Program

Program are available according to the laundry type.

### Jeans

Suitable to wash heavy stained clothes.

### Quick 15'

Suitable to wash light stained clothes and clothes in summer.

### Soft

Slow washing and spinning speed, to prevent wear from deformation.

### Mix

Suitable to wash cotton, linen, flax, jute clothes.

### Normal

Standard fabric washing program, suitable to wash ramie cotton fabric. Wash for once, rinsing for twice, the spin time is a little long.

### Strong

The wash time is longer, the stream is stronger, so the washing effect is better.

### Heavy

Suitable to wash heavy stained / wearable clothes.

### Fuzzy sensing:

The washing machine will select the water level automatically according to the load weight. Once the program, time of washing, number of times of rinsing, and spin time are set, press start button without pressing the water level. the Fuzzy sensing function will work. When there is water in the tub, this will not function.

### T-Clean

Cleans the tub during spinning.

AMERICAN HOME®

Laundry Solution

14



## Maintenance

### CLEANING AND CARE

Before your maintenance starts, please unplug the machine and close the faucet.

### CLEANING THE CABINET

Proper maintenance on the washing machine can extend its working life. The surface can be cleaned with diluted non-abrasive neutral detergents with wet cloth then wipe it with dry clean cloth to dry. Formic acid and its diluted solvents or equivalent are forbidden, such as alcohol, solvents or chemical products, etc.

### CLEANING THE INLET FILTER

Inlet filter must be cleaned if there is less water.

Washing the filter in washing machine:

1. Screw off the inlet pipe from the backside of the machine.
2. Pull out the filter with long nose pliers and reinstall it back after being washed.
3. Use the brush to clean the filter.
4. Reconnect the inlet pipe.

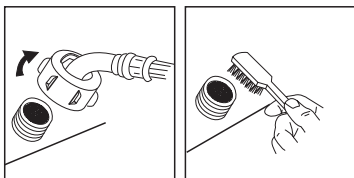

### Lint Filter Clean

1. There is a built-in lint filter in your washer. It can collect lint during washing cycle.
2. It is suggested to clean the lint filter every 10 cycles.
3. Take it out and clean the filter with water. Then place it back into the washer.

#### Magic filter

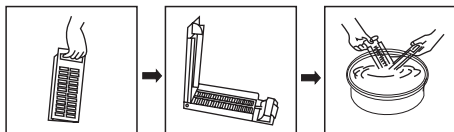

#### Normal filter

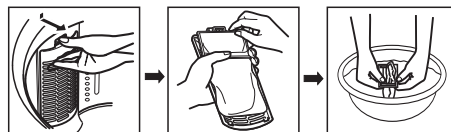

## Maintenance

### CLEANING DRAIN PUMP FILTER

- Be careful of hot water.
- Allow it to cool down.
- Unplug the machine to avoid electrical shock before cleaning.
- Drain pump filter filters the yarns and small foreign matters from the washer.
- Clean the filter periodically to ensure the normal operation of washing machine.

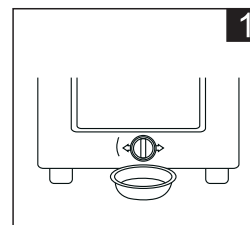

Drain the water out of the pump. Place a container under it to collect the water

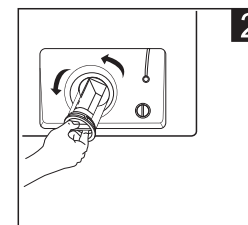

Open the filter by turning counter clockwise

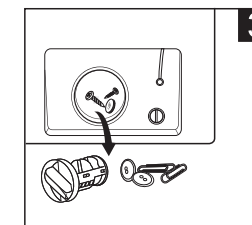

Remove collected pins, screws, etc

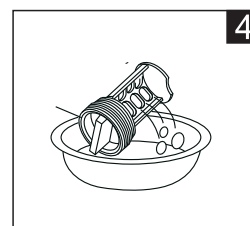

Clean the filter

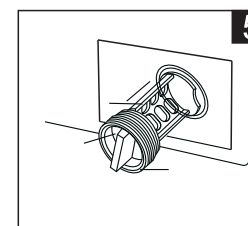

Restore it and adjust the convex place to align to the pump hole

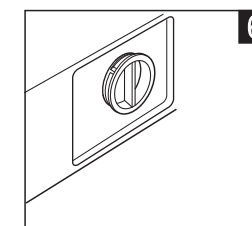

Tighten the pump cover by turning it clockwise

### ! CAUTION

- Make sure that valve cap and emergency drain hose are reinstalled properly, cap plates should be inserted aligning to hole plates otherwise water may leak.
- Some machines do not have emergency drain hose, so step2 and step3 can be skipped. Rotate lower cover cap directly to make water run into basin.
- When the appliance is using hot water, never remove the pump cover during a wash cycle, always wait until the appliance has finished the cycle and is empty. When replacing the cover, ensure it is securely tightened.

## Troubleshooting

When the machine has not started or has stopped operating, try to find a solution first by referring to the items listed below:

Problem	Causes
Does not start washing	<p>If the power is off or the fuse is damage.</p> <p>If the power supply voltage is too low.</p> <p>If the water amount reaches to the required water level. (The washer will not work if the water amount does not reach the required water level).</p> <p>If it is set to "Delay" washing mode. (It will only start to work until the set number of hours is reached).</p>
Not filling water	<p>If the power is off or the fuse is damage.</p> <p>Without water supply or the water pressure is too low.</p> <p>If the inlet hose is properly connected and the faucet is opened.</p> <p>If the filtering screen of inlet valve is blocked by dirt.</p> <p>If the coil of inlet valve is damaged. (The slight electromagnetic sound is normal phenomenon when the inlet valve is switched on).</p> <p>If the "Start/Pause" button is pressed after the power switch is pressed.</p>
Abnormal draining	<p>If the water drain hose is placed very high.</p> <p>If the end of water drain hose is blocked.</p> <p>If the internal rubber ring of drain valve is blocked by dirt.</p>
Abnormal spin	<p>If the door lid is closed.</p> <p>If there is unbalanced load.</p> <p>If the washer is not placed in stable condition or it is placed in inclination state. (The ground is not flat).</p> <p>If the motor belt is loosened.</p>

## Troubleshooting

Error code	Description	Solution
E1	Alarm for abnormal water intake.	Check faucet if open or not.
E2	Alarm for water drain has not finished.	Check the water level sensor and drain pump.
E3	Alarm for open lid before wash and spin.	Close the lid.
E4	Alarm for imbalance load.	Manually balance clothes in the tub.
XX	Others.	Try all over again, if problem is persistent, call the authorized service center.

**Note:** If after checking, the problem is still persistent, call the authorized service center.

## Disposal

### Packaging / Old appliance

This symbol indicates that this product should not be disposed with other household wastes. To prevent possible harm to the environment or human health from uncontrolled waste disposal, recycle it responsibly to promote reuse of material.

